

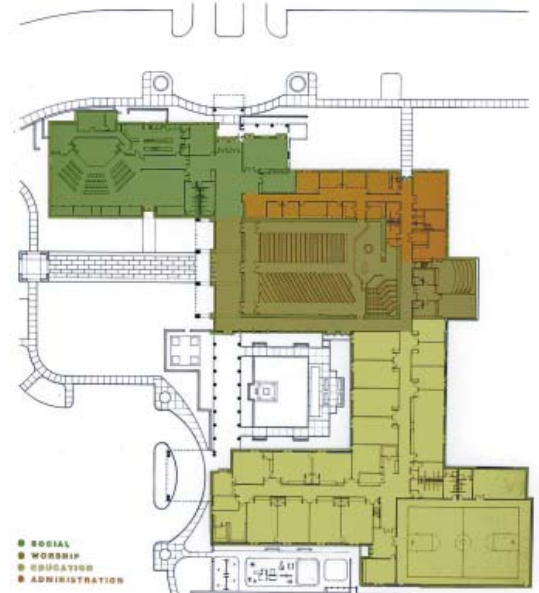

Northpark Presbyterian Church required simplicity and restraint in their new sanctuary and campus, while still wanting a sense of presence on their site at Walnut Hill and Central Expressway. A steeple and steeply pitched roof offer that presence and a sense of tradition, while a modern take on these elements grants them simplicity. The campus includes a new sanctuary, day school, gymnasium, and fellowship hall; all of which orient themselves inwardly to form a quiet garden courtyard that is protected from the nearby highway. The buildings are uniformly wrapped in a light limestone which unites the campus. In the sanctuary, clerestory windows allow for natural light without distracting from the focus of worship. The church's original 1915 stained glass windows have also been incorporated as pieces of art.



NORTHPARK PRESBYTERIAN



FLOOR PLAN

