



2801 Lemmon Avenue West, Dallas, Texas

Key Cataract Surgery Center and Clinic occupies the top floor of this four story office building. Public spaces and an optical shop are at grade with clinical office spaces on intermediate floors, and the majority of the parking is below ground. The site's allowable building envelope and use within the zoning is maximized.

Oglesby•Greene chose green tinted glass, as well as reflective green tint where solar exposures dictate, and two varieties of Texas limestone to provide texture and a subtle regional flavor. Structure is an 8" post-tensioned slab, expressed on the exterior, giving it maximum utilization of its 12' floor to floor height.

2801 LEMMON AVENUE

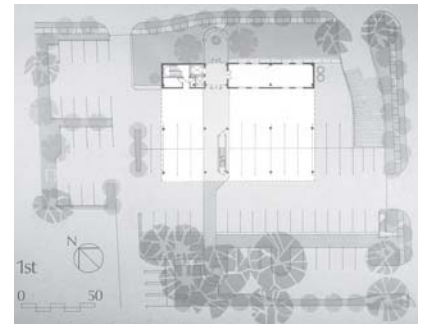

TSA Design Award, 1987
AIA/Dallas Honor Award, 1987